

# PEMBURY VILLAGE NEWS

**Issue 111**  
**Autumn 2002**

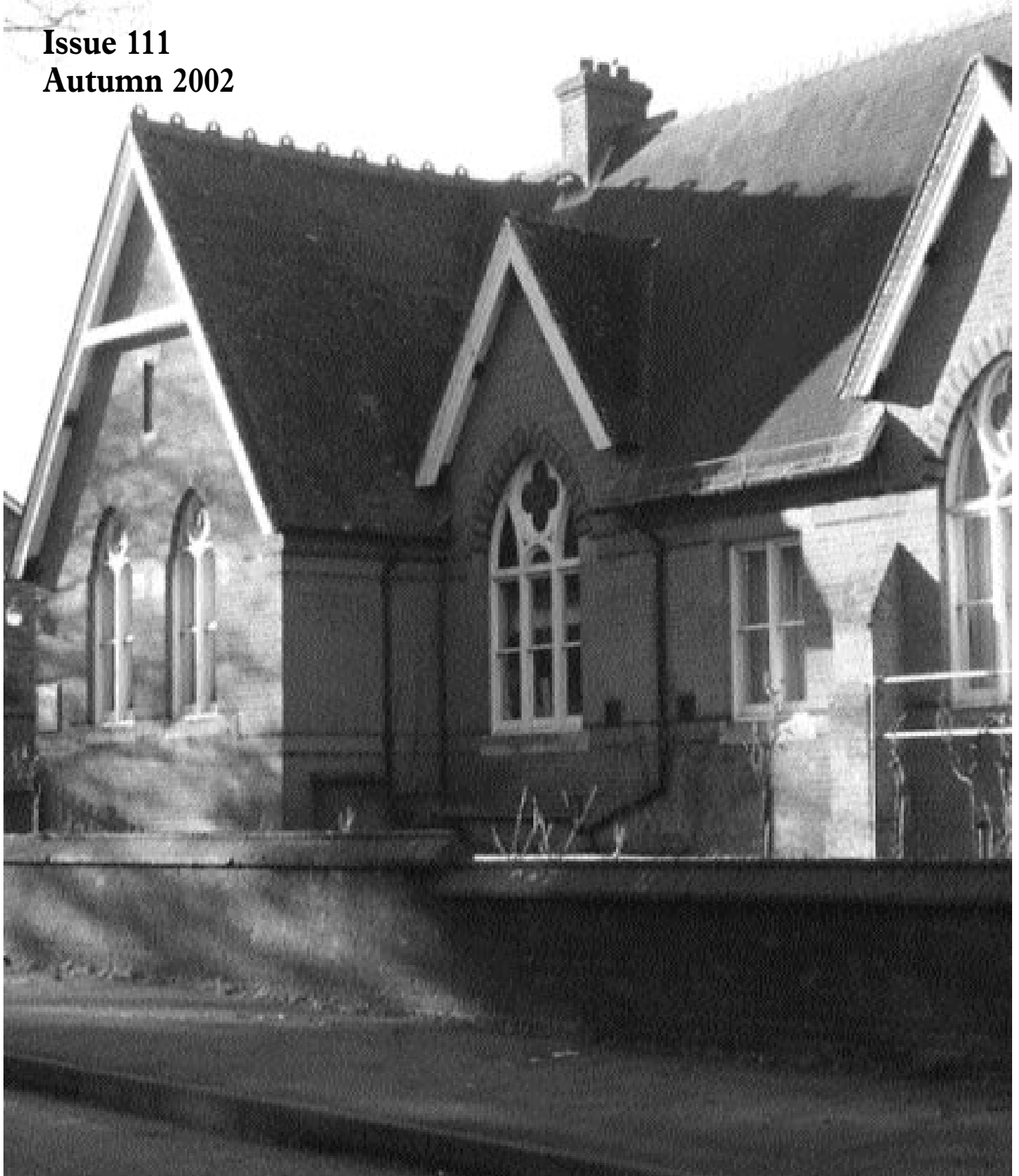

# CONTENTS

News	3	Jan's Garden Views	23
The Queen's Golden Jubilee Events	4	Snippets	25/27
Golden Jubilee High Spirits . . .	5	Neighbourhood Watch	27
Pembury in Bloom	7	The League of Friends of Pembury Hospital	27
Broadband Internet Access for Pembury	9	Pembury in the Past	28
Golden Jubilee Fun Run	9	It's Good to Belong	29
Rubbish Matters	11/12	Beware of Bogus Callers	29
Henwood Green Walking Bus	13	My Plot	31
The Pembury Society	15	Crime in Pembury	33
Pembury People	16/17	For Your Diary	35
Hospice News	17	Rosie's Recipe Corner	36
Challenges for Pembury	19	Your Representatives	37
What's <i>Your</i> Line	20/21	Church Times	37
Pembury Athletic (Youth) FC		Spoonerisms	38
20th Anniversary Season	21	Village Organisations	39

*Cover photograph by Steve Morton*

*Editorial Working Group:*  
Alison Morton (Editor), Paul Barrington-King, Rosemary Latter,  
Ann Owen and Henry Plant

*Please note: The Editor's decision is final on whether or not to publish any item submitted. The Editor reserves the right to edit (that is to cut, précis, alter, correct grammar and spelling) any item published.*

## PEMBURY VILLAGE NEWS

Editor: Mrs Alison Morton  
2 The Coppice, Pembury TN2 4EY  
Tel: 824938 Fax: 825134  
Distribution enquiries: Parish Clerk 823193  
**Email: [pvn@pembury.org](mailto:pvn@pembury.org)**  
**Website: [www.pembury.org](http://www.pembury.org)**

Pembury Village News is published four times a year by the Parish Council, but the views expressed in the magazine do not necessarily represent official council opinion or policy.

Typeset and printed by  
The Meeting House  
Tunbridge Wells.

## NEWS

### PEMBURY PARISH COUNCIL – ALL CHANGE!

**W**ELL, NOT QUITE . . . For various reasons – moving house, taking on other responsibilities, pursuing other interests – several Councillors left Pembury Parish Council. The Chairman, Sarah Clarke, and all Council members, would like to express their warmest thanks for the service given to the residents of the village by Gill Matthews, Richard Crouch, Brian Horgan, Derek Flint, David Mills and Paul Barrington-King. We wish them well in the future.

As is the way of things, new volunteers have come forward and we welcome Leslie Gregory, Gill Pavely, Steve Morton, Nicola Kibble, Sally Osborn and Christopher Rock to the Council.



*Left to right: Left to right, back row – Sally Osborn, Steve Morton, Nicola Kibble, Leslie Gregory; sitting – Gill Pavely, Christopher Rock.*

#### **COPY FOR NEXT ISSUE**

*Any news items or articles for possible inclusion in the next issue of this magazine must be forwarded to the Editor before  
**1st November 2002.***

*If you use a computer to type your article, it would be extremely helpful if you could send it in on disk or by e-mail. If you do not have a disk, we can supply you with one.*

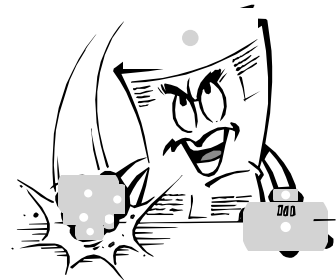

---

## THE QUEEN'S GOLDEN JUBILEE EVENTS

**F**OLLOWING THE Queen's own example, Pembury Parish decided to spread celebrations for the 50th anniversary of the Queen's accession over several months, thus giving everybody in the village the chance to join in at least one of the events. We plan to produce a full report of all Jubilee events complete with colour photographs in the December News. However, here is a brief run-down!



On 18th May 2002, the 1950s Buffet Supper Dance, a 'posh frock/black tie' occasion, was an outrageous success. Guests came dressed in the style of the 1950s and thoroughly enjoyed the live 1950s music and songs performed expertly by West Kent College media students. The memorabilia table was a special success. The raffle raised over £160 for the British Legion.

Saturday 15th June 2002 saw a Musical Picnic On The Village Green. The fancy dress competition for school age children living in Pembury to find the best King and Queen attracted a good number of high quality entrants, making the judges' decision extremely difficult. The winners were Thomas Bridges and Chloe Gibb, with William Grooms and Elizabeth Price as runners up. All four children received a special Golden Jubilee crown as their prize. Although a slightly chilly evening, masses of Pembury residents turned out with their picnics, wine, tables and chairs, rugs, etc. Live music was provided by the Syncopators, mostly light jazz/easy listening plus a light rock/folk group and a brave Highland piper!

Following the success of the Village Fete on the Green last year the Golden Jubilee Village Fete was held on the green on Saturday 20th July 2002. Our King and Queen, winners from the Musical Picnic, opened the fete with great confidence. Although rain was forecast, it was a bright day with a reasonable amount of sunshine! All the usual stalls were present plus new attractions. Music was provided by The Prodigals who got many feet tapping with classic rock and pop songs. At one stage, there were so many people on the green that the grass was no longer visible! £660 was raised for local charities Headway and Compaid.

There is one more Golden Jubilee event to come to finish the series – the Fun Run on 22 September, details from Janet Greenwood on 824472.

---

## GOLDEN JUBILEE HIGH SPIRITS . . .

ONE OF OUR correspondents who lives in Cornford Park sent us photographs of a street party the residents organised for themselves on the weekend of 3rd and 4th June.

Pictured below enjoying the sunshine are:

*(part hidden) Simon Bishop; (standing at back) Elisa Horgan; Angela Cartwright; (back view) Keith Merrin; Debbie Gunning; (standing) Debbie Birch, Joyce Romeo, Mike Birch; (with hat) Mike Cartwright; visitor Jackie; Yvonne Bishop.*



*Taking an impromptu dip in a tub is Heather Purdy with Alan Moxon looking on and Peter Ditchett and Angela Cartwright in the background.*

# Burtons Pembury's Solicitors

- ★ Full Range of Legal Services
- ★ Prompt Efficient Friendly Service

The Tyled House  
23a High Street  
Pembury, Kent TN2 4PH

Tel (01892) 824577

*Member of the National Association of Estate Agents*



**The *Effective* Estate Agents**

**Pembury's leading *Independent* Estate Agent**

**Discuss your property requirements with our qualified friendly staff in comfortable relaxed surroundings**

**★ ★ OPEN 7 DAYS A WEEK ★ ★**

**Giving a personal service to suit your needs**

**16 High Street, Pembury TN2 4NY.**

**Tel: 822880/823099 Fax: 825250 Website: [www.denisebarnes.co.uk](http://www.denisebarnes.co.uk)**

**Also at: Tunbridge Wells: 01892 527733**

**Horsmonden: 01892 724000**

**Prestige & Country Homes: 01892 618181**

**Brenchley: 01892 723922**

**Tonbridge: 01732 500400**

## PEMBURY IN BLOOM

**T**HE FINALISTS of this year's competition met at Notcutts Garden Centre, Tonbridge Road, Pembury on Thursday 22nd August for afternoon tea and to hear who had won – a much guarded secret until the presentation.

Notcutts Garden Centre Manager, Jean Smith, and Gill Matthews of Pembury Parish Council awarded prizes and certificates to the following for their floral feats. The winners are:

### **The Floral Golden Jubilee Award for the Best Golden Jubilee Interpretation**

(new category only for this year)

*1st place:* Mr John Beech, 14 Camden Avenue  
*2nd place:* Mrs Alison Morton, 2 The Coppice.

### **The Best Front Garden Prize**

*1st place:* Geoff and Sally Stafford, 1 Greenleas

*2nd place:* Christine Marsh, 1 Bulls Place

*3rd place:* Ray and Margaret Heasman,  
34 Church Road

*Merits:* Mr Cecil Curd, 12 Stonecourt Lane;  
Mr Ernest Mackleden, 6 Middlefield;  
Mrs Caroline Hine, Spring Court, 1b Henwood Green Road; Miss Sarah Burnham, 15 Heskett Park; Mr Andrew Davis, 55 Hastings Road; Mr Gary Lawrence, 1 Middlefield; Mr and Mrs Clout, 38 Church Road; Mrs P. K. Minter, 62 Herons Way; Mrs Gloria Barton, 49 Hastings Road; Ms Alice Weeks, 2 Bulls Place; Ms Jill May, 3 Bulls Place.

### **The Best Hanging Basket Prize**

*1st place:* Richard Snow and Chris Cooper, Sunflower House, Cornford Park

*2nd place:* Mr Gary Lawrence, 1 Middlefield

*3rd place:* Mr Cecil Curd, 12 Stonecourt Lane;  
Mr Ernest Mackelden, 6 Middlefield

*Merits:* Mr Gavin Groom, 8 The Meadow; Melanie Hambleton, 13 Woodhill Park; Cathrine Aylen, 9 Middlefield; Mrs Alison Morton, 2 The Coppice; Mrs Beryl Daykin, 53 Herons Way; Mrs Caroline Hine, Spring Court, 1b Henwood Green Road; Mr Dennis Langridge, 3 Middlefield; Miss Sarah Burnham, 15 Heskett Park; Mr John Beech, 14 Camden Avenue; Mr Dave Tomkins, 6 The Meadow; 3 Heskett Park; Mrs Pauline Barnfield, 5 Heskett Park.

### **The Notcutts Rose Bowl for The Most Attractive Commercial Frontage**

*1st place:* The King William, Hastings Road.

### **The Notcutts Shield for The Best Allotment**

*1st place:* Mr Fredrick Barden, Woodside Road Allotments

*Merits:* Mr Tony James, Woodside Road Allotments; Mr Norman Brown, Henwood Green Road Allotments.

### **The Best Container Planted and Maintained by a Child**

*1st place:* Bethany Greagsby, 8 Hastings Road

*2nd place:* Catherine Tanner, 6 The Gill.



*From left to right:*  
**BACK ROW:** Jerry Evans  
(The King William),  
Richard Snow and  
Geoff Stafford.

**FRONT ROW:** Christine  
Cooper, John Beech,  
Jean Smith (Notcutts  
Garden Centre manager),  
Bethany Greagsby, Gill  
Matthews (Pembury Parish  
Council), Fredrick Barden  
and Sally Stafford.

# STURGEON'S

ROAD, DRIVE & CIVIL ENGINEERS  
COAL MERCHANTS

PEMBURY 822221/2/3

## Brian V Toogood

CARPETS & VINYLs SUPPLIED & FITTED  
CARPETS & UPHOLSTERY CLEANED



*Stain protection treatment for carpets and upholstery*

FOR PERSONAL & PROFESSIONAL SERVICE TEL: PEMBURY 824252



OVER 28 YEARS' experience.  
EST 1977

Any make of carpet available.  
Pattern books brought to your home.  
Carpet and upholstery cleaning, also rugs  
and orientals.  
Carpets adapted and repaired.

## JILL NOAKES

DRESSMAKER

Pippins Farm, Pembury

*We offer a comprehensive and professional service in all  
forms of curtain making, tie backs and valances.*

*Dressmaking is carried out to a high standard and we  
specialise in wedding gowns made to your designs.*

Full alteration service.

Pembury 823299 or 824260

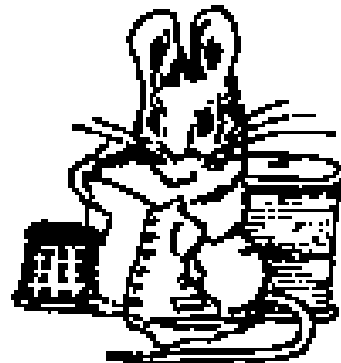

## The Derek Hawes Richards Practice

CHARTERED ARCHITECTS

*Competitive professional design  
consultants. Full range of services  
offered for your needs, from initial  
feasibility study to final acceptance*



Studio 2, Hop Farm East, Macclesfield Court Road, Farnbrook Wood  
Tel: (01892) 838787 \*\*\*\*\* Fax: (01892) 838898



---

## BROADBAND INTERNET ACCESS FOR PEMBURY

### ADSL THRESHOLD LEVEL ANNOUNCED FOR PEMBURY!

ON 1ST AUGUST 2002 BT released the threshold levels for ADSL installation of another 169 telephone exchanges. The good news is that Pembury was the only exchange in this batch to be given the lowest threshold level of 200! With the current level of registrations on BT's demand checker at 102 we are 51% of the way there.

We still need to get the remaining 98 people. Then once BT announce we have met the threshold and convert at least 75% of the 200 in to real orders, ADSL is getting closer than ever!

*(Editor's note: ADSL is a very fast and continuous form of internet connection to which subscribers have instant and 24 hour access. However, BT needs to be persuaded that there is enough local demand to install the local cabling and electronic 'gubbins' before individual residents can join, hence the lobbying campaign!)*

So what next? I have designed an A5 leaflet to put through every door in Pembury but I could do with some help with photocopying and distribution. Do you or your company want to help by sponsoring some photocopying? Do you have time to pop some leaflets through letter boxes in your street? If so drop me an email [Mark.Leman@broadband4pembury.org.uk](mailto:Mark.Leman@broadband4pembury.org.uk).

In the meantime, keep spreading the word – tell your friends, neighbours and people you meet in the street! If they use the internet, point them to the website at [www.broadband4pembury.org.uk](http://www.broadband4pembury.org.uk) and at one of the ISP online registration forms (ISPs who have helped this campaign include Zen internet and Clara net).

If you have any questions, do contact me at [Mark.Leman@broadband4pembury.org.uk](mailto:Mark.Leman@broadband4pembury.org.uk)

**Mark Leman**

---

## GOLDEN JUBILEE FUN RUN

ON 22ND SEPTEMBER 2002 at 11am the Pembury Golden Jubilee Fun Run will take place. The race will start in Stonecourt Lane and be an off-road event in the Pippins Farm area. The course is about 4.5 miles, Paul Barrington-King is preparing a route plan and sorting out final points with David Knight, the proprietor of Pippins Farm.

This is a charity event mainly for Hospice in the Weald, but runners and walkers may participate for any elected charity. The entry fee will be £5 with £1 automatically going to the Hospice. The race limit is 250 participants. Both Esporta and Tesco Pembury are providing logistical support for this event which is being funded by the Parish Council.

Entry forms and posters are available from Janet Greenwood, telephone 824472. Do come along, enjoy a bit of mild exercise and earn a few bob for charity!



# **JULIE ROBINSON** IHBC, BABTAC



**Professional Beauty Therapist**

FULL RANGE OF PROFESSIONAL BEAUTY TREATMENTS AVAILABLE  
WITHIN COMFORTABLE AND PRIVATE SURROUNDINGS



**SPECIALISED DERMALOGICA FACIALS \* ELECTROLYSIS \* MANICURES/PEDICURES  
WAXING \* TOP-TO-TOE TREATMENTS**

*Products do not contain artificial fragrance and are cruelty free.*

*Please telephone for a list of treatment details. **PEMBURY (01892) 824059***

# **E.G. GREEN & SON**

**CARS & LIGHT COMMERCIAL VEHICLE REPAIRS  
FOR ALL BODY & ACCIDENT  
REPAIRS & INSURANCE WORK**

**FREE ESTIMATES**

**01892 544141**

**129 SILVERDALE ROAD, TUNBRIDGE WELLS**

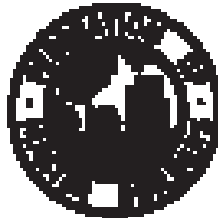

Home Improvements – Extensions – Free Estimates

# **ALAN CLARKE**

***BUILDERS & DECORATORS***

**Tel: Pembury 823932**

---

## RUBBISH MATTERS

**R**UBBISH HAS been a hot topic in Pembury over the past few months. Basically, people have been very unhappy about the sudden withdrawal of the weekly domestic rubbish collection without proper consultation and without due regard to the difficulties that could be encountered by some sections of the community. In general, people have not been too unhappy about the addition of the brown bin for compostable waste, although a significant number thought it irrelevant to them as they either composted all such waste already or didn't have enough to warrant having a second bin on their property.

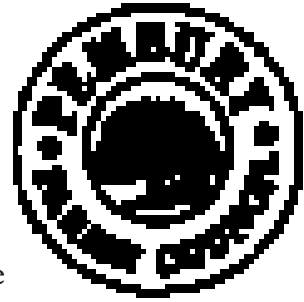

Acting on behalf of Pembury residents, the Parish Council and Pembury's Borough Councillors have been continuously lobbying the Borough Council about the electorate's strong feelings surrounding the new scheme.

Bruce Ballantine, one of Pembury's Borough Councillors, is Chairman of the Scrutiny Committee of Tunbridge Wells Borough Council which is (amongst other things) responsible for reviewing all decisions of the Cabinet. On 2nd August the Committee reviewed a decision of the Cabinet to accept a report from the officers on the operation of the new waste collection system. Councillors Paul Barrington-King and David Mills (both from Pembury) were also there. Bruce reports:

"We heard evidence from Brian Horgan (a resident of Pembury), Allan Bullion (a resident of Sherwood), Councillor Mrs Sarah Clarke (on behalf of Pembury Parish Council) and Councillor Raymond Moon (on behalf of Paddock Wood Town Council). We also received written input from Councillor Hugh Patterson (on behalf of Capel Parish Council). Members of the Scrutiny Committee also spoke.

"There was almost universal agreement about the problems associated with the new system. All speakers stressed that they were not against recycling but the way in which the scheme was introduced and the way in which it was being carried out. They highlighted the problems with the consultation, education and communication processes between the Borough Council and residents and Parish Councils. They highlighted the decision to roll out the system over such a large area initially. They also expressed disappointment that it had been decided not to include doorstep collection of cans, bottles and plastic.

"Their major concern was that the weekly collection of non-compostable waste had been discontinued. They commented on a number of practical problems that this had created for old people, the disabled, large families, people in houses in multiple occupation and people in houses with little storage space and difficult access. Speakers also stressed the hygiene risks, and commented that the level of fly-tipping had increased and that more people were now using the amenity vehicle and the North Farm Refuse Collection site. There were a number of comments that the responses by officers to telephone requests for help had, on occasions, been 'unhelpful'.

"Some speakers also drew attention to the 1999 survey and commented that a number of

---

## RUBBISH MATTERS – *continued*

the questions were so ‘general’ that it was impossible to interpret the answers. But some pointed out that 38% of those surveyed had said they were willing to pay for a better (greener) waste collection service. This is an extraordinary level. Councillor Paul Oliver-Smith replied to the criticisms on behalf of the Cabinet.

“At the end of the discussion, the Scrutiny Committee concluded that something must be done to repair the breakdown in communication between the Borough Council on the one hand and residents and Parish Councils on the other. We recognised that it would not be possible to re-start weekly collections of non-compostable waste in the short term (for contractual and physical reasons), but considered that the Cabinet should consider its re-introduction (as originally proposed by the officers) during the winter when there would be less compostable waste for collection. We also hoped that the Cabinet would take the comments made at the Scrutiny Committee meeting into account when they reviewed plans for the continuation of the scheme and its extension to subsequent phases.

“All Scrutiny can do is make their views known to Cabinet. At their meeting on 1st August the Cabinet agreed to implement a plan to improve communications with residents and Parish Councils. They also agreed to re-consider the re-instatement of weekly collections during the winter period. The Scrutiny Committee will be able to undertake a more fundamental review of the system in November, when a further report on the scheme is submitted to Cabinet.”

Local resident Brian Horgan set up the ‘Action on Waste’ group to represent residents strongly opposed to the new system. He and his colleagues have been lobbying the Borough Council, the media, the local MP, etc. as well as holding regular public meetings. Their website is at [www.actiononwaste.co.uk](http://www.actiononwaste.co.uk)

In the meantime, various national media have been taking an interest in local waste problems; the Pembury Action on Waste group has been contacted by BBC Radio 4 and I have appeared on Channel 5 News re-iterating the Parish council view. Locally, both Kent Messenger and Courier Group newspapers have hosted debates on the subject in their pages.

We need an interactive education and information programme involving local people; a carefully managed and gradual mini-pilot scheme; active listening by the Borough Council; changing things as a result of findings; basically capturing hearts and minds; this is a long business with no short cuts. Of course, consumers need to do their part; refuse excess packaging; re-use plastic bags; take their glass, tins and textiles to the banks and let Borough Council officers know when the bottle and tin banks are full.

I was encouraged to see Spring/Summer 2002 Issue 1 of ‘Tunbridge Wells Recycling News’ drop through my door at the end of August and found helpful tips and information.

Unfortunately, this leaflet is four months too late.

**Cllr Alison Morton, Pembury Parish Council**

---

## HENWOOD GREEN WALKING BUS

ON TUESDAY 21<sup>ST</sup> May, Henwood Green Road Walking Bus attended a picnic in Calverley Park, Tunbridge Wells. Tunbridge Wells Borough Council had organised the picnic for all Walking Buses in the Borough, and six schools were represented – over 150 people. There were pizzas from Pizza Hut, juice from Sainsbury’s, balloons from Kia Cars – a sponsor of the Walking Buses, a visit from Paddington Bear and stories and songs. The picnic was arranged to coincide with national “Walk to School Week” and the first birthday of the St. John’s School Walking Bus. Our Walking Bus will be two in September.

Despite having a roll of nearly 400, Pembury School still has only one Walking Bus – which is a great pity. The children get exercise, it cuts down on the number of cars near the school, it cuts down on pollution and mums don’t have to go to school every morning unless they want to. The bus follows a safe route, checked and agreed by Kent County Council Roads Department; it has a specified adult-to-child ratio for safety reasons, agreed ‘bus stops’ and a timetable to follow.

I’m sure Pembury School could have more walking buses, the Council gives lots of support – you won’t be organising it alone. One day there may be more fluorescent yellow jackets in the School playground!

**Moira Allan, Henwood Green Road Walking Bus**



*Anita Webb, Catriona Allan, Natalie Webb and Alastair Allan at the Walking Bus Picnic*

**European translations**

**Administrative &  
research services**

**Tel: 01892 824833**

**Email: [partners@pbss-uk.com](mailto:partners@pbss-uk.com)**

**Fax: 01892 825134**

**Website: [www.pbss-uk.com](http://www.pbss-uk.com)**

*PBSS – Official hosts of the Pembury Village News web site: [www.pembury.org](http://www.pembury.org)*



# **P. J. & J. M. Ditchett**

## **CHEMIST**

Medicines

Baby Products

Kodak Films

Developing & Printing

Cosmetics

Fancy Goods

Gift Sets

Toiletries

**5 HIGH STREET, PEMBURY ☎ 822896**

# THE PEMBURY SOCIETY

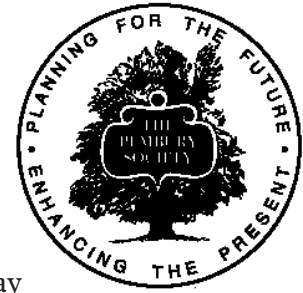

WITH OUR membership growing in numbers all the time, we depend a great deal on our volunteer distributors/collectors who provide the important link between the Management Committee and those who are the body of the Society. We therefore decided to thank them in a practical manner by inviting them and their partners to a coffee morning/meeting. This was held on a Sunday morning in July and to the satisfaction and pleasure of all the committee members who and organised and worked hard to create the event it proved a great success.

Most of our distributors attended and it was a unique opportunity for them to meet each other in such an informal manner. It was also the moment when the Society could show its appreciation of their continued help and support.



*Distributors and Committee members enjoying their coffee morning meeting*

A further success was our participation in the Village Fete on the Green where we had a most enjoyable time providing games for the young and not-so-young and offering Society publications for sale. On such a day of sunshine amidst the sea of smiling faces carried by the several hundred visitors who attended the event it would have been difficult for us not to enjoy the occasion.

By the end of the afternoon those of us who had manned (and

womanned) the stand came away with a great feeling of satisfaction. We have recently invested in a new gazebo so the Pembury Society stand looked attractive and the icing on the cake was that during the fete we signed up a dozen or so new members.

On the evening of 21st October 2002 we have our AGM and Autumn Meeting in the Village Hall. The speaker will be a senior member of the Queen's Golden Jubilee Committee who will describe the planning and management of the arrangements that were made nationwide for the Jubilee. We have been in negotiation with the main organiser for many months and are hoping for descriptions of the many and varied successes of this great enterprise together with a few tales of the things around the country which did not go entirely to plan! All members will receive their newsletter (due to the work of our distributors!) prior to the event but do pencil in the date on your calendar right now so that you don't miss this special occasion.

**Derek Johnson**

## PEMBURY PEOPLE

**F**OR THIS EDITION of Pembury Village News I am grateful to be able to portray the life of another of our village personalities, namely Jim Allwood. He is married to Ruth and they have four children – Stephen, George and Andrew, who are all engineers, and a daughter, Caroline, who is following the family tradition in the nursing profession. The Allwoods moved to Pembury in 1979 and those of us who have been fortunate to visit the family nest, opposite the village school, will have been welcomed by Jim's cheery nature and regaled by tales of his amazing life.



Jim was born a Sussex man in 1925 and spent his early education at Hurstpierpoint College. During his time at college he joined the Clayton Platoon of the 13th Sussex Home Guard in which his father was serving when he was only 15 years old. He could not join the one at the College as the headmaster knew that he was under 17. The Clayton platoon was made up of 'men of the land' who, in the main, were veterans of the Great War and spent their working days on the many local farms. Before being allowed out on patrol Jim was always made to do his homework and he soon began to show signs that he was not your usual 'Private Pike'! The platoon's particular strength in the field, of being able to 'move like cats or poachers at night', came about because of the pipe-smoking activities of three of the men. Prior to the detested drill sessions in the hall these crafty chaps would light up their 'shag' and before the officer arrived it was impossible to see across the hall due to the smokescreen! These sessions would then be cancelled and the platoon would happily troop off for field training.

It is interesting to note how hard people worked during the war. The standard week during this period was 48 hours in addition to many more hours of overtime. Many of the Home Guard duties took place after work and at weekends. Although often doing two-hour shifts through the night they were still ready for work at seven in the morning.

When Jim left school in 1942 he went straight to the Midland Agricultural College to do a crash course in farming. This was then part of the Nottingham University and he obtained a Certificate in Agriculture. During his time at this centre of learning Jim's talents were recognised by a certain Colonel James who arranged for him, although under age, to be recruited via a six-month course at Durham University. Jim was interviewed at 60 Horseguards' Parade and before long found himself as a trooper wearing the black beret of the Royal Armoured Corps. After his course Jim eventually found himself at the Tank Depot in Bovington, Dorset. After his driver/mechanic training he was soon promoted to crew commander of a Cromwell tank. A deferred commission, due to his young age, finally came to fruition and after training at the Royal Military Academy Sandhurst he joined the Reconnaissance Corps. He was then posted to the Yorkshire Hussars Yeomanry, a regiment with wide-ranging skills known as the 'Commandoes with Tanks'.

After the war Jim was deployed to Infantry, Guards and Royal Armoured Corps records and posted to Italy. Upon reaching 21, Jim was promoted to Staff Captain at GHQ 2nd Echelon CMF. After demobilization he rejoined the 24th Sussex Home Guard in a junior



rank after some units had been re-formed at the time of the Korean War and the conflict with Russia. He was, however, not to be let off lightly and soon found himself a Major in charge of A Company.

Upon leaving the Army Jim moved into farming pursuits including running a farm in Isfield, East Sussex. He was later recruited as a head herdsman at Whistler's Farm in Edenbridge and helped build the herd from 75 to 325 cows. The *Farmers' Weekly* soon heard that with one man, 100 cows could be milked in one hour. A reporter was dispatched and with him observing our Jim milked 120 cows in one hour!

Just before leaving the farming profession Jim cast his critical eye over some shoddy building work at the farm. The builder did not take too kindly to this and promptly told him "See if you can do any better mate!" Need I say that Jim could not refuse such a challenge? Off he went with the family to Pembury and bought himself a plot of land. Four years later his lovely house was completed with Ruth being 'very handy when putting the roof on'! Jim offers some wise and sage advice to any aspirant homebuilders: "Build the garage first so that you can practice your skills and if it goes wrong it is not too bad. Having got the garage built, you have a very good lock-up store for the rest of the operation".

These days Jim spends his time doing crosswords, reading and tapestry. He also makes jam and wooden toys. These are sold to benefit the funds of the Friends of the Old Church of which Jim is a committee member. He was responsible for stitching twelve of the wonderful Church kneelers (Ruth added another four!) and was involved with the final sewing-up. Jim views Pembury as an extremely nice place to live but is concerned that 'selfish and illegal parking on pavements is causing invalids and mothers with prams to risk life and limb on the road', a sentiment which I am sure is shared by many of us in the village.

**Paul Barrington-King**

---

## HOSPICE NEWS

**T**WELVE PEMBURY runners were due to take part in the annual Flora Women's 5K Challenge in Hyde Park on September 1st. The hospice had a team of 58 due to run/walk/crawl and we are very grateful to our local runners for their support.

The next participation event is the fourth Fire and Glass Walk Challenge which takes place at The Land Registry in Hawkenbury on the evening of October 31st. So far 154 walkers have taken part in these events raising valuable funds for the hospice. Both events are run by Blaze, a professional company from Nottingham, who run expert training sessions before participants walk. Spectators are also welcome; there will be a firework display and quiz to entertain them. For further details and entry forms for this unique event, apply to Richard Snow at the Hospice on 01892 820534 or check out our website on [www.hospiceintheweald.org.uk](http://www.hospiceintheweald.org.uk).

Dedication forms for the Hospice Tree of Light are available from the reception desk at the Hospice from mid-September. Help us to make the Hospice Christmas tree even more special this year by adding your dedication to a loved one.

The volunteer office is looking for any spare card index boxes that hold cards 6" x 4". If you can help, please contact Kim Brophy on 820529.

# HEAD-MASTERS

01892 822879

welcome all new and existing clients.

*Specialist in Easi-Meshe Hilights in one or more colours. Cutting & Perming*

Opening times: Mon – 9–5.30. Tues – 9–6. Wed – 9–5.30 Thurs – 9–7. Fri – 9–6. Sat – 9–4

## *New* BEAUTY AT HEAD-MASTERS

B.A.B.T.A.C. REGISTERED. BTEC QUALIFIED

A full range of beauty treatments are available, including the Exclusive skin care range by Sothys of Paris, which is only available in Salons, and JESSICA Nail Care for that up-scale Luxury Manicure and Pedicure.

Beauty at Head-Masters is open late on Thursday night and gift vouchers are available for that different kind of gift.

Please pop in for a pricelist or simply call Beauty at Head-Masters and we will send a price list to your home.

Treatments available – Various Facials to suit all • Luxury Manicures and Pedicures • Special occasion makeup • Various Body treatments • Self-tanning treatments • Waxing • Plus much more for your individual needs.

# PEMBURY VILLAGE HALL

Available for hire.

**Facilities include Main Hall, Meeting Room, Stage,  
Kitchen, Changing Rooms and Services.**

**Ideal for Club Meetings, Weddings, Anniversaries,  
Corporate Functions, Shows, Dances, Musical Events, etc.**

**Contact Bookings Manager – Rachel Windus on 822837**

# CHALLENGES FOR PEMBURY?

*We were recently asked what the main challenges facing Parish and Town Councils over the next five years would be. David Coleman, Vice-Chair of Pembury Parish Council, replies.*

**O**BVIOUSLY, THE subject is immense so I have had to restrict myself to some fairly brief and general points.

## **The Future of Local Council**

The Rural White Paper in 2001 set out a number of enhancements in the role of Parish Councils, ranging from a more active position in local strategic planning to facilitate improved public transport. Unfortunately, the back-up work by the Countryside Agency has been patchy in the actual engineering of how, where and when – and the Government has not yet addressed topics as diverse as funding or the actual legal role of parishes in the local plan process, relying rather on hoping for increasing local co-operation between District Councils and Parishes. Districts are not always that keen, unfortunately.

The 'Quality Parish Council' concept is another Government initiative based upon the general Best Value and Quality Council requirements now placed upon principal authorities. Whilst only those parishes with a gross annual precept of over £500,000 (usually Town Councils) have to comply with the Quality criteria, all parishes are expected to follow the principals of robust rules and financial procedures, engagement with the local community and compliance with the 'Four Cs':

*Challenge* all preconceived ideas;

*Consult* with all stakeholders in the local community;

*Compare* own service standards with others who are 'doing it better' and

*Compete* to ensure where possible there is continuous improvement.

As you can see, quite a challenge!

There are also new rules set out in The Code of Local Government Conduct where again, like principal authorities, parishes are required by law to adopt and maintain very strict formal standards involving declarations of interest and not being part of decision is which one has an interest - very challenging in small communities!

## **The Problems**

The first major problem is changing legislation. This government has brought in repeated changes to the structure of local decision making with fundamental implications for much of rural life. The most worrying are proposals to change the way planning works set out in the Planning Green Paper in late 2001. This

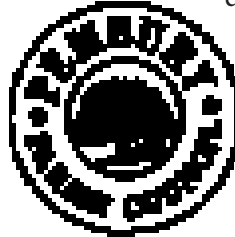

proposes a regional approach to strategic planning (and just think how big and diverse the South East is . . .) and a huge drop down to district planning frameworks for actual local land use – with no County Structure Plans in between. This is linked to the intention to build two million new houses in the South East and is likely to bring major local problems. In Pembury we should not be affected too severely given our tight Metropolitan Green Belt, but at best nearby communities like Paddock Wood could see substantial house building expansion and at worst the green belt and rural safeguards could go for everyone. Likewise, changes to funding, local government structure through regionalisation and the agricultural industry could all bring about massive pressures on the countryside.

## **Pembury Issues**

For Pembury, in addition to the above, we have several areas of policy to pursue over the next five years:

- A21 – campaign for the duelling of the stretch between the Pembury By-pass and Tonbridge;
- A228 - campaigning for the road safety improvement of the section between Pembury and Crittells Lane;
- Pembury Hospital - campaigning for a new hospital on the Pembury Hospital site as soon as possible;
- Local Plan Review - ensuring the sustainability of the Pembury sections of the revised local Plan;
- Local Community Development - continuing our policies of developing the sense of local community and the engagement of everyone in our community. Already we have a new Village Hall, a robust and well read local 'Pembury News', an excellent web site and are developing information exchanges, etc;
- Recreation 'Five Year Plan' – Continuing to implement our five year plan in the recreation grounds;
- Quality Parish and Best Value – Continuing to review and improve our services;
- Tesco site – addressing proposals for enlargement of the Tesco store to ensure the best for Pembury residents;
- Local Planning – a continuous battle to safeguard and improve Pembury.
- Highways, parking and traffic calming – trying to ensure the safest and most sustainable street environment in Pembury – particularly with schemes for High Street, Lower Green Road and in the area of Pembury School.

**David Coleman,**

Vice Chair, Pembury Parish Council

---

## WHAT'S YOUR LINE

**M**OST OCCUPATIONS speak for themselves and usually we understand the basics. But occasionally perhaps we are a bit vague about a particular description. Take the word 'architect', for example. It could be the architect of the Cold War, or the architect of the campaign to avert the damage of global warming. But probably the first words that come to mind are 'designer' and 'draughtsman'.

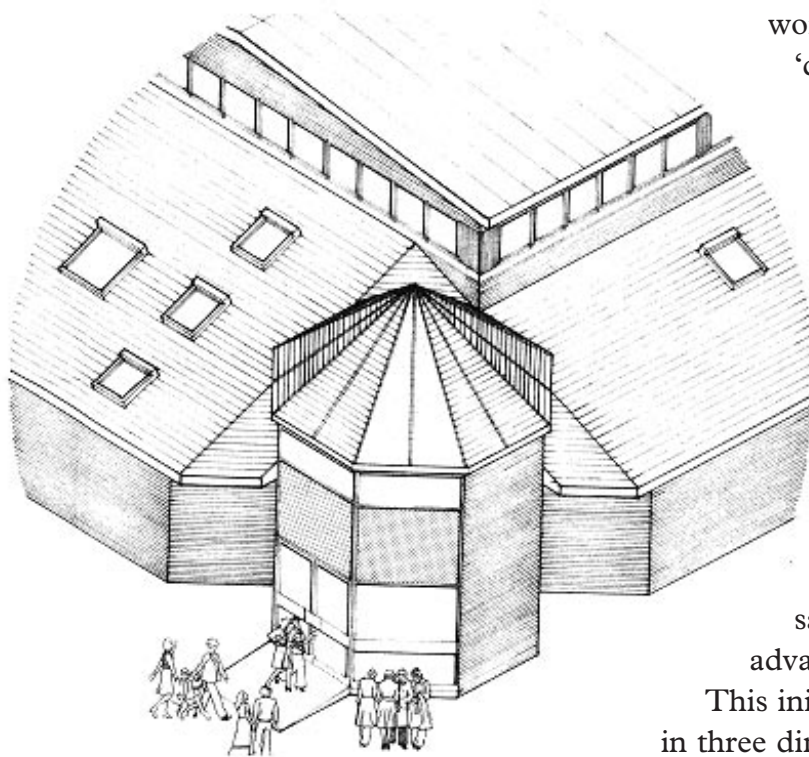

At least we all know an architect can design, but it may come as a surprise to readers if I said that this is a small element of his or her work in time terms (incidentally, where are all you budding lady architects?). Every design has to be tailor-made within the restrictions of a particular site, but at the same time taking maximum advantage of its potential assets.

This initial exploration has to be done in three dimensions. Yes – length, breadth and height! Development of this ability to think 'in the round' is one reason why it takes seven years to train an architect.

The initial stage of a building project is absolutely crucial. I can perhaps best illustrate this by highlighting some of the considerations that had to be taken into account in the design of what is now our new Village Hall.

First, the site – houses on three sides and a shared driveway to it from the High Street was quite a challenge. Second, the accommodation – a main hall obviously, but also a sound proof second space, a luxury never provided by its predecessor. The Hall was to have a stage for local and touring dramatic and singing groups, to bring a new dimension to entertainment in Pembury. Changing rooms would be needed and a kitchen to provide for a 300-plus audience. Not forgetting the usual facilities. Third – the sore point raised by so many enquirers – where is Pembury's Hall?

Well, down to the drawing board with the 6B pencil. The Hall size was basically fixed by the dimensions for badminton and short-mat bowls. So a juggling act was undertaken to fit all the smaller spaces around it, ending in the almost inevitable compromise. Not everyone could be a winner. And, of course, all the facilities had to be accessible from the

---

entrance. It seemed logical to place this at the corner of the building to which everyone would have to come.

Once inside, three choices presented themselves – left, centre or right. But that solution assumed visitors had actually found the Hall!

The idea that I put forward to the Parish Council was to design a prominent vertical feature, to make the new Hall as visible from the High Street as possible. Within the very severe site limitations, an octagonal entrance foyer with a turret for the roof was agreed. This would provide the Hall with a real welcome for all, an asset that the previous building sadly lacked.

I mentioned three-dimensional thinking earlier and this became a very important element of the final design. The Hall was to be mechanically ventilated to avoid disturbance to neighbours and, together with the central heating plant, the equipment would take up an enormous space. However, there is a substantial fall from the driveway approach to the fields behind and the difference between the levels was used to fit the engineering needs under the stage together with storage space for the tables for functions. In addition, the back stage area was planned with its own rear entrance for scenery and access – when money permits.

In conclusion, that matter of time. Design work started in July 1996 and the planning application was made in September. It took another four years for permissions, funds and building to be completed. But that first three months was critical.

**Derek Hawes Richards FRIBA**

---

## PEMBURY ATHLETIC (YOUTH) FC – 20th ANNIVERSARY SEASON

**P**EMBURY'S YOUTH football club are celebrating our 20th Season of competitive football this season. To mark the occasion the Club has decided to compile a history from September 1983 to current times.

We would like to hear from anyone who has managed, played, supported or had any sort of contact with the Club. We need the following information: Team details; Team statistics; Manager's names; Helpers names; Team achievements; Photographs; Memorabilia; Artefacts; Contacts – names and address of people involved who have left the area.

Maybe you have an anecdote or interesting story? Anything connected with the Club would be most welcome and all items loaned will be returned.

If you have anything to offer, please call **Laurie Frowde** (tel. 822826, email. [themeetinghouse@lineone.net](mailto:themeetinghouse@lineone.net)) or **Ben Coombes** (tel. 822105, email: [bencoombes@aol.com](mailto:bencoombes@aol.com) Please respond by end of November.



WEDDINGS PARTIES DANCES DISCOS BIRTHDAYS

CONFERENCES ANNIVERSARIES

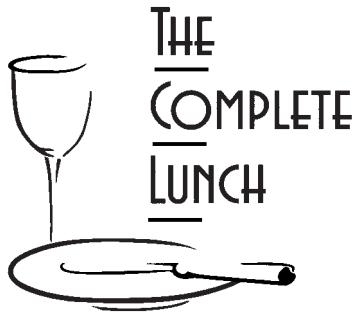

FUND RAISING EVENTS CHRISTENINGS FUNERALS

Outside & Corporate Catering  
Quality Food – Good Value

Family run business that caters in  
homemade and healthy food

– 30 years experience –

Choose from Finger or  
Dressed Buffets to  
Hot Three Course Dinners



Visit our website @  
[www.thecompletelunch.co.uk](http://www.thecompletelunch.co.uk)  
or Phone/Fax us on 01892 824937



### Memorials, Restoration and Domestic Stonework

Benhall Mill Road  
Tunbridge Wells  
Kent TN2 5JH  
Tel: 01892 526 733  
[www.burslem.co.uk](http://www.burslem.co.uk)

New Memorials, Cleaning,  
Renovation of Memorials and  
Additional Inscriptions.  
Brochures available



## JW Services (Pembury)

MOBILE CAR REPAIRS AT HOME  
OR WORK

• BREAKDOWN FACILITIES •

**ALL makes of cars including Citroen  
& Diesels repaired and serviced.**

**Full Service:**

**4 CYLINDERS: £65**

**6 CYLINDERS: £75**

SECONDHAND CARS BOUGHT AND SOLD  
(WITH OR WITHOUT MOT)  
MOBILE CAR PHONES SUPPLIED AND FITTED

**PHONE JIMMY WEBB**  
**825212 (Home)**  
**0860 270293 (Mobile)**

## D.S.B LANDSCAPES

- PRIVATE AND COMMERCIAL HEDGE AND LAWN CUTTING
- LAWN CARE SERVICES
- LANDSCAPE CONSTRUCTION
- GARDEN CLEARANCE
- GENERAL GARDEN MAINTENANCE

REASONABLE RATES –  
FREE QUOTATIONS

**Tel: 01892 823217**  
(answerphone)

## JAN'S GARDEN VIEWS

*We would like to give a warm welcome Jan Davies who has taken on Gill Matthews' column as Gardening Correspondent and will be giving us tips and advice for each season.*

**H**ELLO! I will try to be as informative as Gill and I am sure we all wish her well in her new home and garden in glorious Devon.

I hope you have all been enjoying the results of your labours and relaxing in the (occasional!) sun in your gardens. Now is a good time to cast a critical eye over your plants and assess whether you are satisfied the way they are. Have they performed well? Do some need moving? Are there any gaps to fill? While the soil is still warm you can transplant perennials and shrubs while the garden layout is still evident; keeping the new outer growth of older plants. Also, any new perennials, if you don't want to wait till next spring, and cuttings or seedlings grown during the summer. Add a slow-release fertiliser and some well-rotted manure.

Evergreens, trees and shrubs can be planted throughout the autumn, but beware of early frosts. After planting, mulch with a 2" layer of shredded bark or compost to protect young plants during their first winter. Mulching in the autumn produces stronger, more vigorous plants and can be used throughout the flower garden.

Cut back the spent stems and foliage of perennials that have finished flowering to ground level except some tender ones where it is beneficial to leave them for frost cover and cut back in the spring, e.g. penstemons and some salvias.

Tidy beds and borders of spent annuals and falling leaves as the autumn progresses. Add them to the compost heap for your lovely home-produced compost next year! Lift tender fuchsias and pelargoniums. They should be protected and sheltered for the oncoming winter, as with dahlias and

gladioli. Dry and store them in a frost free place.

Bulbs are plentiful for choice now and are such a welcome sight in Spring after the long winter. Dwarf daffodils make much less foliage and are good in small gardens, rockeries or containers.

They make a cheerful display in the house on a light window-sill (but away from radiators) along with deliciously scented hyacinths. Plant them soon in time for Christmas. Tulips are best planted in November. There is such a wonderful variety of types and colours; plant them in groups for early and late displays along with wallflowers and the blue of forget-me-nots. Darwin tulips are very reliable and give repeat performances year after year without the need for lifting. Beware of squirrels and mice that like to make a meal of small bulbs!

Winter flowering pansies will make you smile with their cheerful upturned faces. Plant them with small evergreens in window boxes or containers.

Lawns – aerate, scarify and re-seed worn patches and apply fertiliser. Turf can be laid now and through October, or sow seed for new lawns. Protect with cotton to deter hungry birds.

Tall roses need a light pruning of hips, dead flowers and long shoots to protect from wind-rock. Leave the main pruning until early March.

For your ponds, remember to feed fish now, as live food is becoming scarcer and they need to build up reserves for the winter. Tidy the area around the pond and cover with netting to catch falling leaves.

Happy gardening!

**Jan Davies**





## **HOLIDAY COTTAGES at BRENCHLEY**

Also available for short term lets (e.g. relocations)

View at [www.maycottages.co.uk](http://www.maycottages.co.uk)

or more information contact Mrs. Allen

Email [margaret.allen@lineone.net](mailto:margaret.allen@lineone.net)

☎ **01892 824373**

# **P.L.H. DECORATING**



Interior & Exterior

Painting – Decorating

Property maintenance

**PEMBURY 823813**



**SOUTH EASTERN  
ORTHODONTICS**  
Malcolm C. Pratt

## **SOUTH EASTERN ORTHODONTICS**

29 High Street, Pembury

Tel. 01892 822296 (Daytime)

01892 822964 (evenings and weekends)

**QUICK AND EFFICIENT DENTURE  
REPAIR SERVICE**

## **David Salter**

**Gas & Plumbing Services**

Central Heating Installations & Upgrades

Boiler & Cylinder Changes

Breakdowns, Connections & Servicing of all gas appliances

15 Years experience with British Gas

Corgi Registered



**EMERGENCY CALL OUTS – MOBILE 07733 107333 – HOME 01892 824481**



---

## SNIPPETS

### **FIREWORKS**

First of all, do make a note that Pembury's grand firework display will be held in the Recreation Ground on the evening of 8th November. Look for the big sign on the Village Green for the start time. This proved very popular last year and so the Parish Council wanted to do it again. See you there!

---

### **PATHWAYS**

Do you know the 'little path' that goes up the bank outside two houses in Henwoods Green Road (approx opposite the end of Sweeps Close)? All the school children walk along the path and have obviously done so for many years. Caroline Mazzey (822493) would be interested to know if anybody knows how long the little path has been there.

---

### **BIKES IN WOODS**

Following various complaints about motor bikes in the woods Peter Every, Parks Technical Officer, advises that the gates and signs are now in place and appear to be having the desired effect. He reports, "I have had no new reports of bikes or quad bikes using the woods. I, along with our consultant, Dolwin and Gray have attempted to contact South East Water who own part of the woodland to alert them of the problem but as yet without success. I have been in contact with the police at Pembury who will monitor the situation, should the problem continue Kent Police Traffic Section have an off-road unit which can be deployed."

---

### **KENT COLLEGE HEAD RETIRES**

After 12 years as headteacher of Kent College Barbara Crompton retired in July. Under her leadership, the independent girls' school has grown and gained improved facilities including a new sports hall in 1999 and the Judi Dench Theatre this year.

She said: "I am most proud of the girls' achievements – ready to seize opportunities and to go for it. They didn't do that 12 years ago. One of the great joys is seeing pupils

leave and know they are well prepared to go on to great things."

After 30 years of teaching, Miss Crompton will be enjoying a gap year with "no commitments and lots of travelling". Her successor is Anne Upton, former deputy head of Burgess Hill School for Girls.

---

### **RELAX AND CHILL OUT . . .**

Reflexology, aromatherapy and Indian head massage 'taster' sessions have been held on the first Monday of each month in August and September in the Village Hall. The next one is on Monday 7th October from 11am to 1pm, cost £3 per adult, £1 for children. Contact Julia Mummery on 512839 for more details.

---

### **ROTARY CHANGE**

After 31 years since it was founded, the local Rotary Club has announced a change of name from the 'Rotary Club of Southborough' to the 'Rotary Club of Southborough and Pembury' to reflect the fact that it also serves the village of Pembury. It has always had a close affiliation with Pembury School and the League of Friends of Pembury Hospital. Pembury residents wishing to find out more should contact the Secretary Mike Raper on 822095

---

### **A FOOTBALL RESULT . . .**

Steve Spear e-mailed us about the 1977/78 football photo which appeared on page 21 of the Summer News. He writes: "*The last ?? (i.e. the one with the 'modified' hands and arms) is me, Steve Spear. I had a lot more hair in those days!). I have recently moved back to the UK after living in Denmark for eight years. It was a nice surprise to see the photo in the PVN.*"

---

### **CLUB FOR DISABLED PEOPLE?**

Harry Dott from Snipe Close contacted us about his wish to start up a club for disabled people in Pembury. He hopes people of all ages will come together on a regular basis for activities and maybe trips out. The club



Self Employed? Then you know what it's like trying to keep all the balls in the air at one time – while you'd rather be doing business and making money.

Inland Revenue, VAT, CIS forms, PAYE, Companies House returns . . . take your eye off any of these and the fines appear.

Give Mike Withycombe a ring and we can talk about setting you free to concentrate on what you do best. After all, you never wanted to be a self-employed juggler!

## CULLENS AT PEMBURY

CHARTERED ACCOUNTANTS

13 HIGH STREET, PEMBURY. Tel. 01892 823034 – 07786 084851

Kent College Pembury



*Independent girls' day and boarding school. Ages 3-18. Christian foundation 1886.*

*If you are looking for a school with a difference, then Kent College Pembury offers a dynamic, forward-thinking learning environment where your daughter can develop the knowledge and skills to succeed in a competitive modern world.*

*Visit for a tour of our impressive facilities and discover how a philosophy based on nurturing individual achievement works for our students.*

- Junior School (ages 3-11) and Senior School (ages 11-18) share a beautiful 75-acre campus.
- **High academic standards: 61% A\* and A grades in GCSEs in 2001. Listed 163rd in The Times' Top 800 Schools. 53% A & B grades in A-level. 45% A grades at AS-level.**
- Academic scholarships, and music and drama awards available at 11+, 13+ and Sixth Form.
- Impressive record of achievement in sports, music and drama.
- Exciting and diverse range of extra-curricular activities.
- Local daily transport provided, flexible boarding and after school care.

**For a prospectus please contact:**

**Senior School - 01892 822006 Junior School - 01892 820204**

**Old Church Road, Pembury, Tunbridge Wells, Kent TN2 4AX.**

**Website: [www.kent-college.co.uk](http://www.kent-college.co.uk)**



---

## SNIPPETS – *continued*

would be run by disabled people themselves, but able-bodied helpers would be most welcome. For further details please contact Harry Dott on 07796 423392

---

### NEW HOSPITAL

The planning permission application for a hospital on the Pembury site was passed unanimously by the TWBC Planning Board on 14th August with no changes to the Conditions approved at the Western Area Planning Committee.

---

### A21 ROUNDABOUT

The roundabout joining Longfield Road, Castle Hill, the Pembury by-pass and Tonbridge Road had a sudden, very close shave a few weeks ago. It was quite stunning to see what a difference it made to see all the vegetation stripped away. We understand that it was necessary in light of the new developments on the North Farm Industrial

Estate, particularly the new large retail units. Obviously, they will mean an increase in traffic flow and this entails alterations to that junction.

---

### HAPPY BIRTHDAY

We hear that birthday congratulations are due to Mrs Cora Walters of Sunhill Court. Mrs Walters was 100 years old on 3rd September – Happy Birthday indeed!

---

### SOME HEALTHY EXERCISE . . .

We spotted a Three Churches Walk with Alan Dane on 29th September in the High Weald 'Around the Weald in 49 Days' events leaflet. It's a five mile walk taking in Pembury, Tudeley and Capel Churches and views of the Medway valley. Meet at Pembury Old Church (off the A228) at 2 pm. Please contact Kent High Weald Project on 01580 715918 to book your place. £2 donation to charity.

---

## NEIGHBOURHOOD WATCH NEWS

**G**ILL PAVELY, The Neighbourhood Watch Co-ordinator for Pembury and Tudeley, tells us that the Police/ Neighbourhood Watch stand at the village fete in July was a great success. The display attracted a lot of attention and several people expressed an interest in becoming actively involved in the local scheme. Please contact Gill on telephone 822605 for more details and an information pack Moira Allan and Wendy Plane, 1st and 3rd Pembury Brownies.

---

## THE LEAGUE OF FRIENDS OF PEMBURY HOSPITAL

**T**HE LEAGUE OF Friends has done it again! Once again the target of £13,000 was reached and so the hospital will be able to take delivery of the vital piece of new machinery in the Ophthalmic Department – a Humphrey Fields Analyser which provides sophisticated diagnosis for conditions such as glaucoma and cataracts. This will be of use to the vast majority of patients and covers all ages.

When Laurie Mayer was invited to officially open the Fete he was asked to bring good weather and, true to his promise, he did! He, along with the Mayors of Tunbridge Wells, Tonbridge and Malling and Southborough supported the Fete enthusiastically and stayed well into the afternoon. When Laurie left he was not as well dressed as when he arrived; he had auctioned off two of his ties to help swell funds!

**Ken Marsh**

## PEMBURY IN THE PAST

### 1945 Street Party – Were you there?

**C**ELEBRATING HAS been the theme of many events in Pembury in this Golden Jubilee year and this set one of Pembury's long-time residents thinking about

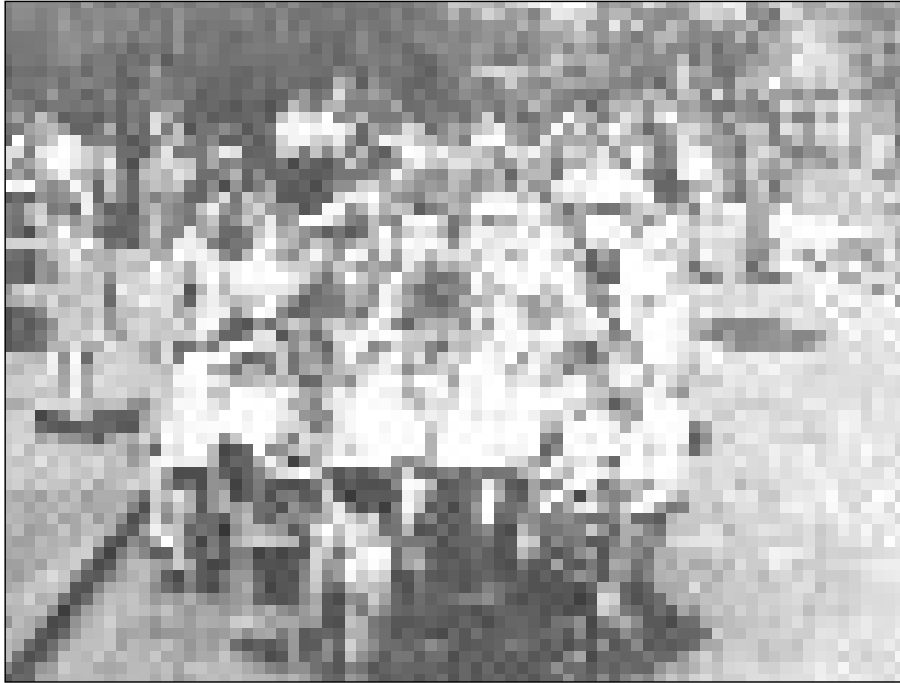

celebrations in the past. Gordon Jury, who used to live in Canterbury Road, contacted us with these photographs of a street party held there at the end of the Second World War. John Cripps, who was Gordon's neighbour, lent him the photographs and we wondered how many former 'children' and their families can remember being there.

The second photo was taken from the upper floor of no. 21 Canterbury Road and also shows the building known as the 'tin chapel' although Gordon does not think it was ever used as such.

So far, we have Gordon and his sister, Sylvia; Brian Killick; John Cripps (a.k.a. 'Kipper'); Fred Tester, Peggy Kirkham (Mrs Tester); Mrs Miles; Millie Duke; Mrs Eva Cook and two of her four sons, Eddie and Bill; Mrs Vi Botten; Georgie Stone; Tony Bateup; Brian Elliott; Micky Johns

Gordon tells also how Mr Tapp, who was the greengrocer at the top of Canterbury Road, provided a box of fireworks for the celebrations that had been buried in his garden 'for some time'.



---

## IT'S GOOD TO BELONG

**A** SENSE OF belonging has developed in the past year since my wife Joy and I moved to Pembury. As we joined the community we were so warmly welcomed that we settled quickly into our new home. Possibly living on the High Street with the comings and goings at the Village Hall helped, but we soon felt we belonged.



Safety rules must be observed. I am willing to accept jokes about “playing trains”! It is in fact a serious business running a preserved railway, but an opportunity to form friendships with a group of people who share a common interest.

The latest thing is joining the Parish Council. It is interesting to discover how

It was the same when we attended Pembury Baptist Church. We wanted to join and become part of its vibrant life. It was a strange and partly amusing experience being part of the membership course. We’ve been Christians for 60 years and have often run such courses ourselves, but it all helped to confirm that we belonged there too.

We have joined the Pembury Society. We have yet to attend any of their meetings, but sense that this is another part of belonging to the village.

I have recently become a volunteer on the Kent and East Sussex Railway. This involves a different set of expectations and Health &

little you have to reveal about yourself other than your criminal record!\* But here is a way to give back to the community in recognition of what Joy and I have received by acceptance and inclusion during the past year.

It’s good to belong! Many of you who read this know what I mean. If anyone doesn’t, then make an effort to join something in the village so that together we can all feel we belong to Pembury and that Pembury belongs to us.

**Leslie Gregory**

*\*(Wait until you see the code of conduct forms, Leslie! – Editor)*

---

## “BEWARE OF BOGUS CALLERS AGAIN” WARNS KENT FIRE BRIGADE

**K**ENT FIRE BRIGADE is advising householders to be careful when answering the door to people who claim to be associated with the fire service, especially with the launch of this year’s Home Fire Safety Checks. The warnings follow a number of enquiries from members of the public who have been visited or telephoned by people claiming to be associated the fire service and offering fire safety advice.

Brigade Press Officer, Station Officer Lee Rose, said “There are a number of checks you can make to verify whether a person works for Kent Fire Brigade. If the person is a genuine firefighter they will be dressed in a

uniform with a clearly visible Kent Fire Brigade badge. All the brigade staff carry identification and will be very willing to show this. If there is still doubt you can ring our headquarters on 01622 692121 and ask us to confirm that the person calling does work for Kent Fire Brigade.”

He added, “There are a number of community fire safety initiatives currently being undertaken throughout the county which involve making Home Fire Safety checks and being invited into people’s homes to offer advice. These visits are carried out by professionally trained staff and do not involve selling anything.”

# G. F. GROVES

Your friendly local builder

CARPENTERS  
JOINERS

BUILDING  
CONTRACTORS

**EXTENSIONS/CONVERSIONS/NEW-BUILD**

*PLANNING SERVICE AVAILABLE  
PURPOSE-MADE JOINERY*

**FREE ESTIMATES • FAST SERVICE**

**Telephone (01892) 838619**

## Dawn Hodgson

MSSCh MBChA

## Chiropodist



- Professional Advice and Friendly Care
- Diabetic Assessment & Maintenance
- Verruca Treatment, Natural Remedies or Chemical
- Ingrowing Toenail Care
- Treatment for Fungal Infections
- Day, Evening and Saturday appointments available

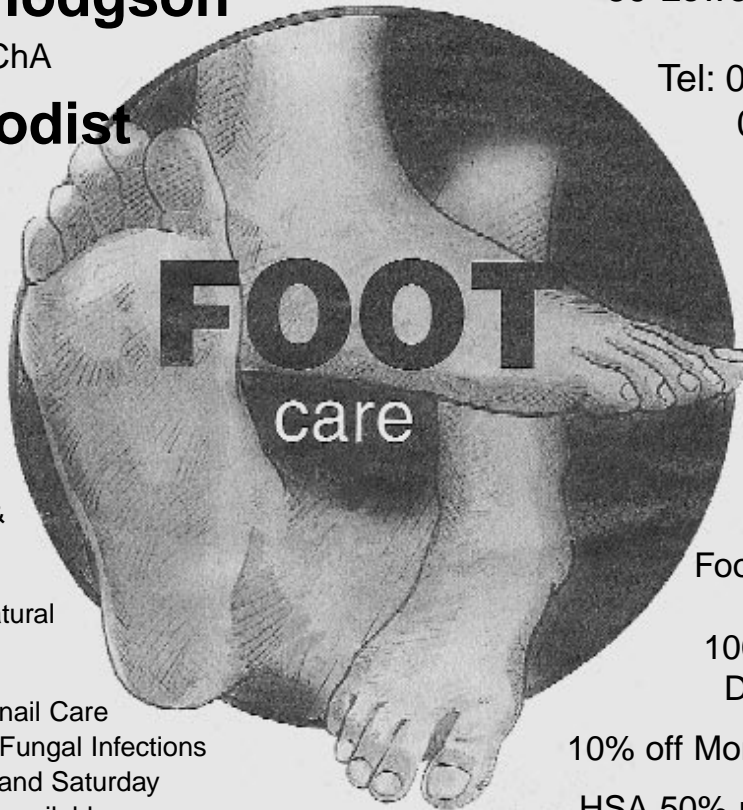

59 Lower Green Road  
Pembury  
Tel: 07761 583 756  
01892 824916

Full range of  
Footcare products,  
including  
100% Natural and  
Diabetic Friendly

10% off Mondays over 65's  
HSA 50% refund available

---

## MY PLOT

**I**MUST TRY not to be too negative, but on the other hand I have to confess that this summer has been a disaster!

My big problem was the wood chips that I thought were so great. After they had finished keeping the weeds down last winter, we rotovated them into the ground in the spring. Unfortunately, just as they were good at stopping the weeds from growing, so were they at stopping my crops from growing too. Onion setts didn't grow, carrots and beetroot wouldn't germinate and potatoes didn't develop properly. The only things that did not suffer were the beans and peas. If you want to learn more about what went wrong, look up 'nitrogen robbery'. What I now know is that I must keep the chips to areas where I don't want anything to grow for a long time, for example paths. Meanwhile, I'm hoping that the chips will have completely rotted by next year and to help re-fertilize the ground, I'm going to grow field beans over the winter.

My autumn raspberries have turned out to be bullies – productive, but complete thugs, sending up suckers at large distances from where they are supposed to be. I don't yet know how much of a nuisance this is going to be.

After all the moaning, it's been a good year for my soft fruit – raspberries, gooseberries, currants, plums blackberries and loganberries. The only disappointment was the strawberries, though I think that was because they were sulking after I transplanted them into nice neat rows. They'll be back next year.

I grew asparagus peas that were new to me and turned out to be popular and very pretty. The flowers were bright red and it made trouble-free ground cover. It was very hard to spot the peas among the leaves and even when I'd 'got my eye in' it was hardly a bumper crop. Still, I had enough surplus to freeze some and I'd grow them again another year.

A couple of years ago, I grew a root crop called skirret that was like a cross between carrots and parsnip. It was really nice and has turned out to be perennial. What seems to happen is that as the roots are so long that bits snap off and stay in the ground. They then re-grow the following spring. I wonder if carrots or parsnips could be grown that way?



**Caroline Mazzezy**



## Peter Willard Conservatory Specialist

Your Local Supplier of Top Quality

UPVC Conservatories. Any size and

Many Different Styles.

Just call *NOW* for a Free Estimate

*...A Complement to Your Home*

Telephone no. 01892 824736      Mobile no. 07950 120341

*'The family Nursery  
and terracotta importers  
on your doorstep'*

**HIGHEST QUALITY  
AT THE LOWEST PRICE!**



KINGS TOLL NURSERY  
Maidstone Road on B2160  
Tel: 01892 824474

Bedding/Patio Plant Growers : Shrubs & Perennials : Trees : Bulbs :  
Bare rooted hedging : Loose seed potatoes, onion & shallot sets :  
Specialist in Citrus, Olive Trees & Hardy Palms : Vegetable & Herb Plants :  
Hanging Baskets & Pots planted to order or ready made – always available :  
Fresh flowers – weekly : Large range of houseplants.

Over 1,000 varieties of terracotta and glazed pots, urns, novelties and  
ornaments imported directly from all over the world.

Helpful advice – Carry to car service – Local deliveries – Garden Services

**OPEN 7 DAYS A WEEK**



## CRIME IN PEMBURY

**T**HE REPORTED crime figures for the quarter April, May and June show an increase over the previous quarter of 54 versus 40. Percentage-wise, this is a big increase but due to the varying methods of reporting crime this last quarter's figures include a much larger street plan than the previous quarter.

The three crime types which are showing a worrying increase are criminal damage, fraud and deception and theft and all we can keep repeating is the same message. If you see someone's property being damaged ring the police – it could be your turn next. If you see someone behaving suspiciously, ring the police and be extra careful especially shopkeepers, traders and petrol stations for the people who drive off without paying or using dodgy credit cards or posing as some kind of official.

As the darker evenings come in, before retiring for the evening just have a quick look around outside and make sure that you have not left anything unlocked or equipment outside that can be stolen.

Just a few weeks ago, there was a meeting in the village hall with local and senior police officers from the Kent Police and Borough Council representatives where parishioners could ask questions relating to policing concerns in Pembury. The main concern without a doubt was poor police response to telephone calls to parishioners wishing to report incidents. We were given various reasons as to why such as regrouping of police staff and facilities but with the promise that there would be a considerable improvement when everything was in place.

Please remember to use those two telephone numbers (emergency number 999, other calls 01732 740055) when wishing to report incidents but please be patient and give the police a fair and reasonable time to respond. However, if you do experience a long delay then please let me know and I will raise the issue with the police.

The other serious issue raised was that of speeding traffic and illegally parked vehicles. We can tell you that there will be a blitz on speeding drivers, especially Hastings Road and the High Street and Lower Green Road – all of which have a **MAXIMUM SPEED LIMIT** of 30 mph. Please don't let us have the embarrassment of the main offenders being the parishioners of Pembury. The Parish Council will also be researching different methods of highlighting the speed restriction areas and potential danger areas around the village by varying road markings and signage.

**Hugh Boorman**

MONTH	Assau	Assault	Robbery knifing	Robbery other	Criminal Damage	Fraud and Deception	Traps	Other offences	Theft from Motor Vehicles	Theft of Motor Vehicle	Vehicle Damage	Theft of Houses	Other Offences	TOTAL
<b>April 2002</b>	2	1		3	4	2	1			1		3		<b>17</b>
<b>May 2002</b>				1	5	4		1	2		1	4		<b>18</b>
<b>June 2002</b>		4	1		5	4				1	1	3		<b>19</b>
<b>TOTAL</b>	<b>2</b>	<b>5</b>	<b>1</b>	<b>4</b>	<b>14</b>	<b>10</b>	<b>1</b>	<b>1</b>	<b>2</b>	<b>2</b>	<b>2</b>	<b>10</b>	<b>1</b>	<b>54</b>
<b>ROAD</b>														
Beagles Wood Road					1									<b>1</b>
Church Road		1									1			<b>2</b>
Elmhurst Avenue							1							<b>1</b>
Hastings Road	1	1	1		5									<b>9</b>
Herwood Green Road					7				1	1		1		<b>10</b>
Hurons Way		1												<b>1</b>
High Street						10					1	1		<b>12</b>
Lower Green Road	1			2					1					<b>4</b>
Maidstone Road				1										<b>1</b>
Tonbridge Road		2		1						1		8	1	<b>13</b>
<b>TOTAL</b>	<b>2</b>	<b>5</b>	<b>1</b>	<b>4</b>	<b>14</b>	<b>10</b>	<b>1</b>	<b>0</b>	<b>2</b>	<b>2</b>	<b>2</b>	<b>10</b>	<b>1</b>	<b>54</b>

# J. C. WOOD

PAINTER & DECORATOR

Est. 1984

INTERIOR & EXTERIOR PAINTING • PAPER HANGING  
ALL HOUSE MAINTENANCE • NO JOB TOO SMALL

**Telephone: Pembury 824877**

## AMBERSIDE DANCE STUDIO *PEMBURY VILLAGE HALL*

Pre-School Creative Movement Classes for Boys and Girls

Ballet, Modern and Tap Dancing Classes for all ages.  
ISTD Grades and Examinations

**Please Contact: Margaret King AISTD – Pembury 822574**

## WALROND FULLER CHARTERED BUILDING SURVEYORS

01892 709600

STRUCTURAL SURVEYS AND ADVICE ON LISTED  
AND PERIOD PROPERTIES

## **Kempsters** The Funeral Directors

A family business that has served the community since 1882

**A COMPLETE 24 HOUR FUNERAL SERVICE**

**2-4 ALBION ROAD • TUNBRIDGE WELLS**

**Telephone: 01892 523131**

Be thoughtful, take out a  
GOLDEN CHARTER  
PRE-PAID FUNERAL PLAN



---

## FOR YOUR DIARY

**REGULARS** – Village Market – Village Hall Thursdays 9.30am – 12noon

### October

- 1 Darby and Joan Club – Village Hall – 2 pm
- 2 St Peter's Mothers' Union: 'Problems facing Christian doctors today' – Upper Church – 8 pm
- 3 Pembury Afternoon WI : 'The Jewel in the WI Crown' – Village Hall – 2.15 pm
- 4 Pembury Evening WI: Kent Women: Famous, infamous, unsung – Village Hall – 7.45 pm
- 5 Pembury Footpath Walkers – depart Bo Peep Corner – 2.15 pm
- 6 Harvest Thanksgiving – Upper Church – 9.45 am
- 6 Service for Countryside & Wildlife with Kent Wildlife Trust – Old Church – 5pm
- 7 Parish Council Meeting – Village Hall – 8 pm
- 7 St Peter's Photographic Club: Upper Church Meeting Room – 8 pm
- 12 Pembury Sequence Dance Club: Annual Dinner Dance – Village Hall – 7 pm
- 13 Service for the Recently Bereaved – St Peter's Upper Church – 6.30 pm
- 14 Floral Art – Village Hall – 8 pm
- 15 Darby and Joan Club – Village Hall – 2 pm
- 19 Pembury Bowls Club: Race Night – Village Hall – 7 pm
- 21 St Peter's Photographic Club: Upper Church Meeting Room – 8 pm
- 21 Pembury Society AGM – Village Hall – 7.30 pm
- 26 Pembury Gardeners: Jubilee Dance – Village Hall – 8 pm
- 29 Darby and Joan Club – Village Hall – 2 pm
- 31 Hospice in the Weald: Fire & Glass Walk – contact Richard Snow 820534

### November

- 1 Hospice in the Weald: AGM – Ramada Jarvis Hotel – 2 pm
- 1 Pembury Evening WI: AGM – Village Hall – 7.45 pm
- 2 Pembury Footpath Walkers – depart Stonecourt Lane – 2.15 pm
- 2 RNLI Autumn Fair – Village Hall – 10.30 am to 12.30 pm
- 4 Parish Council Meeting – Village Hall – 8 pm
- 4 Hospice in the Weald: Christmas Market – Hospice -11 am to 4 pm
- 6 St Peter's Mothers' Union: 'Peril on the Sea' – Upper Church – 8 pm
- 4 St Peter's Photographic Club – Upper Church Meeting Room – 8 pm
- 7 Pembury Afternoon WI: AGM – Village Hall – 2.15 pm
- 7 Hospice in the Weald: Glitz Fashion Show – Hospice – 7 pm to 10 pm
- 8 Pembury Village FIREWORKS – Recreation Ground, Lower Green Road – 7.30 pm
- 10 Remembrance Sunday Service – Upper Church 10.50 am
- 11 Floral Art – Village Hall – 8 pm
- 12 Darby and Joan Club – Village Hall – 2 pm
- 16 St Peter's Autumn Fair – Upper Church – 10.30 am
- 18 St Peter's Photographic Club – Upper Church Meeting Room – 8 pm
- 23 Pembury Bowls Club: AGM – Village Hall – 7pm
- 26 Darby and Joan Club – Village Hall – 2 pm

### December

- 2 Parish Council Meeting – Village Hall – 8 pm
- 2 St Peter's Photographic Club – Upper Church Meeting Room – 8 pm
- 4 St Peter's Mothers' Union: Christmas Supper – details to be advised
- 5 Pembury Afternoon WI: Christmas Party – Village Hall – 2.15 pm
- 5 Hospice in the Weald: Tree of Light Dedication Service and Carols – 7 pm
- 6 Pembury Evening WI: Christmas Decorations – Village Hall – 7.45 pm
- 7 Pembury Footpath Walkers – depart Camden Car Park – 2.15 pm
- 9 Floral Art: Party – Village Hall – 8 pm
- 10 Darby and Joan Club – Village Hall – 2 pm

## ROSIE'S RECIPE CORNER

Well, the school holidays are over and I hope you all enjoyed them. The days are getting shorter and the shops will start filling up with Christmas goodies. However, before we start thinking of that I shall kick off with a recipe that you can use at any time. This recipe was always popular with my family when they were younger.

### Chicken Pie with Herb Topping

*Ingredients:* Preparation time: 20 minutes.

Serves 4 people

2oz/50g streaky bacon, chopped

2oz/50g mushrooms, sliced

4oz/100g cooked chicken

2 carrots, cooked and sliced

1/2 pint/3 dl chicken stock or water and chicken stock cube

1 level tablespoon cornflour

Salt and pepper

6oz/175g self raising flour

3oz/75g margarine

2 level tablespoons chopped parsley

Cold water to mix

Fry the bacon in a saucepan until the fat runs. Add the mushrooms and fry until softened. Add the chicken, cut into bite-sized pieces, then the carrots and the stock. Mix the cornflour with a little of the stock then return it to the pan. Bring to the boil, stirring constantly, until thickened. Season with salt and pepper. Pour into a shallow ovenproof dish. Sift the self raising flour into a bowl and rub in the margarine until it resembles fine breadcrumbs. Stir in the parsley and a pinch of salt then enough cold water to make a soft dough. Roll out the dough to fit the dish and place it on the chicken mixture. Mark with a knife to make a diamond pattern. Bake in a hot oven (400°F/200°C Gas mark 6) for 15-20 minutes or until well risen and golden.

Alternatively, you can substitute the chicken for turkey and the carrots for peas.

Bonfire night can often be a very chilly night, so why not make a nice big bowl of heart warming soup before you go to that organised display on the Recreation Ground. You can warm it through when you get home. This soup will keep your guests guessing as to what it is!

### Pumpkin Soup

*Ingredients:*

1 1/2-2lb (or 3 cups) cooked pumpkin

1tbs margarine or butter

1tbs plain flour

1tbs brown sugar

Salt, pepper, ginger, cinnamon to taste

4-6oz finely chopped ham

1/4pt single cream

Stir all ingredients together over a low heat until well mixed. Add cream last, do not boil.

**DON'T FORGET TO SAVE SOME UNCOOKED SEEDS TO PLANT NEXT YEAR!**

Lastly, if you are anything like me and you are trying to keep those calories to a minimum over the Christmas period then here is a recipe for

### LOW CALORIE MINCE PIES

*Ingredients:*

1lb mincemeat

1 8oz cooking apple

1 lemon

6oz self raising flour

3oz low fat margarine

Peel and grate apple into mincemeat.

Grate rind of lemon and add with juice to mincemeat. Mix flour and margarine with water to make pastry and roll out thinly.

This recipe should make 24 mince pies at 125 calories each or one fat unit each.

Please send your recipes to:

81 Beagles Wood Road, Pembury, TN2 4HZ

or you can ring me on 822059 or

email: [rosie@latter.fsworld.co.uk](mailto:rosie@latter.fsworld.co.uk)

## YOUR REPRESENTATIVES

### County Council

Mr Kevin Lynes, 5 Downs Cottages, The Down, Lamberhurst, Kent TN3 8EX. Tel:890922

### Borough Council

Mr Bruce Ballantine, 6 Maidstone Road TN2 4DD. Tel: 822156

Mr Paul Barrington-King, 22 The Coppice TN2 4EY. Tel: 825144

Mr David Mills, 125 Ridgeway TN2 4ET. Tel: 825577

### Parish Council

Cllr Hugh Boorman, 52 Henwood Green Rd TN2 4LH. Tel: 823068 *Amenities, Allotments and Environmental Improvement Contact*

Cllr Mrs Sarah Clarke, Little Stanton,  
Romford Road TN2 4AY. Tel: 823932

Cllr David Coleman, 22 Ridgeway TN2 4ER. Tel: 823402

Cllr Mrs Janet Greenwood, 1F Beagleswood Road TN2 4HX. Tel: 824472

Cllr Leslie Gregory, 47 High Street TN2 4PH. Tel: 822343

Cllr Miss Nicola Kibble, 68 Herons Way TN2 4DN. Tel: 823326

Cllr Mrs Rosemary Latter, 81 Beagleswood Road  
TN2 4HZ. Tel: 822059

Cllr Mrs Alison Morton, 2 The Coppice TN2 4EY. Tel: 824938

Cllr Steve Morton, 2 The Coppice TN2 4EY. Tel: 824938

Cllr Mrs Sally Osborn, 34 Canterbury Road TN2 4JT. Tel: 824938

Cllr Mrs Gillian Pavely, 52 Maidstone Road TN2 4DE. Tel: 822605

Cllr Christopher Rock, 14 Heskett Park TN2 4JF. Tel: 822300

Cllr Mrs Wendy Withycombe, 23 Westway TN2 4EX. Tel: 823034

### Clerk to the Pembury Parish Council

Mrs Barbara Russell, 6 The Grove, Pembury, Kent TN2 4BU. Tel: 823193.

Email: PemburyPC@hotmail.com

*Chairman of Parish Council  
Vice Chairman of Parish Council  
Planning Contact*

*Finance Contact*

*Public Relations and  
Christmas Lights/  
Pembury in Bloom Contact  
Pembury Village  
News Editorial Contact*

## CHURCH TIMES

### ST. PETER'S CHURCH SERVICES

#### Upper Church

8.00am Holy Communion  
9.45am The Parish Eucharist  
and Junior Church  
10.00am Holy Communion  
(Wednesdays)

#### Old Church

11.30am Matins (except  
first Sunday, Holy  
Communion)  
Evening services as advertised  
on Church noticeboards

### CATHOLIC CHAPEL OF ST. ANSELM - PEMBURY

Sunday Mass 10.30am  
Holy Days - Vigil Mass  
7.30pm  
Confessions:  
Sunday 10.15am

Weekday Service:  
Wednesday - Mass 7pm

### PEMBURY BAPTIST CHURCH

We praise God and hear his  
word on Sunday at 10am  
and 1st and 3rd Sunday at  
7pm.

We have many activities  
during the week for mums,  
toddlers, young people and  
senior citizens. Ring the  
church office 825590 for  
details.

*Beautiful Nails*

*by Priscilla G Thorp*

*Mobile Nail Technician & Manicurist*

*Hands prepared for weddings, manicures & heavy hand treatments,  
pedicures & foot treatments (available from 8am).  
Nail extensions & all sorts of nail art available.*

*To arrange your treatment or for enquiries, contact Priscilla on 01892 825678*

## Janes' Ironing Service

- \* Free collection
- \* Massive mile radius covered
- \* Professional service at an affordable price
- \* Free delivery
- \* Guaranteed 2 day turn around
- \* Competitive prices



**CALL NOW - 01892 824092**

## The Creative Curtaining Company



We offer a very highly experienced design  
and make service exploring all options  
for that perfect window treatment.



For a friendly, free consultation call Nicky Callow on  
01622 812584 / mobile 07759 830711 - Watlington

## SPOONERISMS

**D**R WILLIAM SPOONER, a 19th century Oxford academic, used to get his speech muddled and gave us the word 'spoonerism'. Here are a few - some old, some new.

you hissed my mystery lecture  
a blushing crow  
we'll have the hags flung out  
go and shake a tower  
it's roaring with pain  
lack of pies

you missed my history lecture  
a crushing blow  
we'll have the flags hung out  
go and take a shower  
it's pouring with rain  
pack of lies

# VILLAGE ORGANISATIONS

## AGE CONCERN

Mrs Sandra Springett. Tel.: 522591

## ALZHEIMERS DISEASE SOCIETY

Simon Rooksby, Pineview Day Hospital  
Pembury Hospital. Tel: 823535, Ext 3515

## BEAVERS, CUBS AND SCOUTS

Mike Cartwright, 16 Cornford Park, Pembury.  
Tel: 823235

## BLACK & WHITE MARCHING MILITAIRE

Tel: Louise 823097

## BOWLS CLUB

Len Birnie. Tel: 01892 681222

## BROWNIES AND RAINBOWS

Mrs J. Fichtmüller, 19 Belfield Road. Tel: 823002

## BURMA STAR ASSOCIATION

Secretary: Mr R. G. G. Whitlock, 6 The Forstal.  
Tel: 822115

## CATHOLIC CHURCH

Deacon Bill Eason. Tel: 824133

## COMMUNITY WORKING GROUP

Hugh Boorman. Tel: 823068

## COMPAID TRUST

Computer Aid for Disabled People. Tel: 824060  
Transport for Special Needs. Tel: 823488

## CONSERVATIVE PARTY

Terry Cload, 56 Herons Way. Tel: 823966

## CRICKET CLUB

Hon. Secretary: Andy Weaver. Tel: 824362

## DARBY & JOAN CLUB

Mrs Doris Down. Tel: 822323

## FRIENDS OF PEMBURY HOSPITAL

c/o Pembury Hospital. Tel: 823535

## FRIENDS OF PEMBURY PARISH CHURCH

Chairman: Mrs S. Clarke, Little Stanton,  
Romford Road. Tel: 823932

## GIRL GUIDERS

1st Pembury Company: Mrs A. Baker,  
Tel: 0771 264 3946

## HEADWAY

Libby Slattery. Tel: 823120

## HIGH WEALD HOUSING TENANT'S

## CONSULTATIVE COMMITTEE

Ray Heasman. Tel: 822675

## HOSPICE IN THE WEALD – PEMBURY LINK GROUP

Chris Cooper. Tel: 825428

## HOSPICE IN THE WEALD

Maidstone Road. Tel: 820500

## KENT COLLEGE

Headmistress: Anne Upton. Tel: 822006

## KENTISH VALE ROUND TABLE

Mr Everden. Tel: 834685 or 832823 (business)

## LABOUR PARTY

Dave & Sally Osborn, 34 Canterbury Rd. Tel: 822726

## LARKFIELD

Principal: Mr Roger Gibson, Cornford Lane. Tel: 822168

## LAWN TENNIS CLUB

Mrs S. Smith, 2 Ridgeway. Tel: 822405

## LIBERAL DEMOCRATIC PARTY

Bruce Ballantine. Tel: 822156

## LITTLE RASCALS (formerly 'Meet-a-Mum')

Alison Burgess. Tel: 515714

## NATIONAL CHILDBIRTH TRUST

Co-ordinator: Helen Dunkerley. Tel: 822529

## NATIONAL FEDERATION OF THE BLIND, UK

Michael Coggles. Tel: 822705

## NEIGHBOURHOOD WATCH

Gill Pavely. Tel: 822605

## PEMBURY ATHLETIC (Youth) FOOTBALL CLUB

David Gow. Tel: 824119

## PEMBURY BRIDGE CLUB

Geoff Plummer. Tel: 824652

## PEMBURY F.C. SATURDAY

Mick Waterman, 26 The Coppice. Tel: 824137

## PEMBURY F.C. SUNDAY

P. Craxton, 31 Batchelors. Tel: 823928

## PEMBURY FOOTPATH WALKERS

N. & K. Franklin, 11 The Meadow. Tel: 823212

## PEMBURY BAPTIST CHURCH

Pastor David Graham  
Church Office. Tel: 825590

## PEMBURY GARDENERS

Ann Purton. Tel: 824223

## PEMBURY PHOENIX TWIRLERS

Dave or Chris Brett. Tel: 824233

## PEMBURY PLAYERS

Chairman: Mrs G. Norman Draper. Tel: 823975

## PEMBURY PRE-SCHOOL NURSERY

Mrs C. Hughes. Tel: 668514

## PEMBURY SCHOOL

Headteacher – Mrs K. Thewlis. Tel: 822259

## PEMBURY SCHOOL ASSOCIATION

Linda Bowen. Tel: 825536

## PEMBURY SCHOOL HOUSE NURSERY

Teacher in charge: Rosemary Rich. Tel: 825580

## PEMBURY SEQUENCE DANCE CLUB

Secretary: Mrs Marion Warren. Tel: 547617

## PEMBURY SHORT MAT BOWLING CLUB

Arthur Storey. Tel: 822509

## PEMBURY SOCIETY

Derek Johnson. Tel: 823150

## PEMBURY STOOLBALL CLUB

Mrs Sandy Rice-Tucker. Tel: 822483

## PEMBURY UPPER AND OLD CHURCH

Rev. Stephen Sealy. Tel: 824761

## PEMBURY VILLAGE MARKET

Sue Boreham Tel: 824385  
Eve Fiddimore Tel: 518277

## ROTARY CLUB OF SOUTHBOROUGH & PEMBURY

Secretary: Mike Raper. Tel: 822095

## ROYAL NATIONAL LIFEBOAT INSTITUTION

Peter Chartres, 54 Woodhill Park. Tel: 823759

## SANDRA'S HOUSE

Pre-School Nursery, Mrs S. Toogood, Queens Folly,  
64 Lower Green Road. Tel: 824252

## SCOUT & GUIDE HQ MANAGEMENT TEAM

Mike Cartwright, 16 Cornford Park, Pembury.  
Tel: 823235 and Jackie Fichtmüller, 19 Bellfield Road,  
Pembury. Tel 823002

## ST. PETER'S MOTHERS' UNION

Secretary: Mrs J. Tompkins. Tel: 823123  
Branch Leader: Mrs J. Aust. Tel: 823963

## ST. PETER'S PHOTOGRAPHIC CLUB

Events Secretary, Carol Wakeford. Tel: 822030

## TABLE TENNIS CLUB. John Burleton. Tel: 823250

## TREE WARDENS. Pat Cookson. Tel: 825739.

Caroline Mazzey Tel: 822493

## TUNBRIDGE WELLS & DISTRICT VICTIM SUPPORT SCHEME. Tel: 513969

## VILLAGE HALL

Manager (bookings): Rachel Windus.  
Tel: 822837

## WOMEN'S INSTITUTES

Afternoon: Mrs Edna Morris. Tel: 822267  
Evening: Mrs Sylvia Strudwick. Tel. 822631

## WRVS LUNCH CLUB

Tel: 822737

## YMCA

Simon Stanley. Tel: 534444

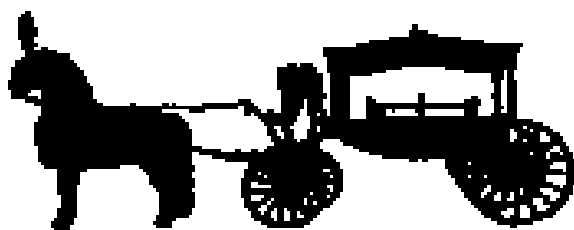

# **T. W. BOORMAN FUNERAL SERVICES**

(An Independent Caring Family Funeral Directors)

31 Mount Ephraim

**Tunbridge Wells**

Kent

TN4 8AA

**01892 541070**

(Opposite the Kent & Sussex Hospital)

6 Shipbourne Road

**Tonbridge**

Kent

TN10 3DJ

**01732 773202**

(Opposite Tonbridge School)

AT A TIME OF BEREAVEMENT, YOU WILL  
NEED THE CARE, SENSITIVITY AND  
PROFESSIONALISM FOR WHICH WE ARE  
RENOWNED.

**24 Hour Service**

Own Floristry Department

Service Sheets Available

No Charges for Last Respects

Monuments and Headstones

**Discretion assured at all times**